

PATIENT STARTING GUIDE

INSTRUCTIONS FOR USING YOUR NEW PEN

SULIQUA[®] 100/50 pen (10-40)

(100 units/mL insulin glargine + 50 µg/mL lixisenatide)



SULIQUA[®] 100/33 pen (30-60)

(100 units/mL insulin glargine + 33 µg/mL lixisenatide)



Both pens can be used in the same way, but it is important that you are using the pen that you have been prescribed.
Check with your doctor, nurse or pharmacist if you have any concerns about using your pen

**PLEASE MAKE SURE YOU THAT READ THE PATIENT
INFORMATION LEAFLET PROVIDED WITH YOUR SULIQUA[®]
PEN FOR MORE INFORMATION**

WHAT IS SULIQUA® AND WHAT IS IT USED FOR?¹

SULIQUA® IS AN INJECTABLE MEDICINE FOR TYPE 2 DIABETES, CONTAINING INSULIN GLARGINE (100 UNITS/ML) AND LIXISENATIDE

This medicine is used in the treatment of type 2 diabetes in adult patients and is taken with metformin when other medicines (like oral antidiabetics or basal insulin) are not enough on their own to control your blood sugar levels. **If you use any other antidiabetic medicine, discuss with your doctor whether you should stop using that medicine when starting SULIQUA®**

SULIQUA® COMES IN TWO DOSES AND IS DELIVERED USING THE SOLOSTAR® PEN¹

YOU WILL HAVE BEEN PRESCRIBED ONE OF TWO AVAILABLE SULIQUA® PENS, WHICH ARE BOTH USED IN THE SAME WAY. MAKE SURE THAT YOU USE THE PEN THAT YOU HAVE BEEN PRESCRIBED. CHECK WITH YOUR DOCTOR, NURSE OR PHARMACIST IF YOU HAVE ANY CONCERNS ABOUT USING YOUR PEN

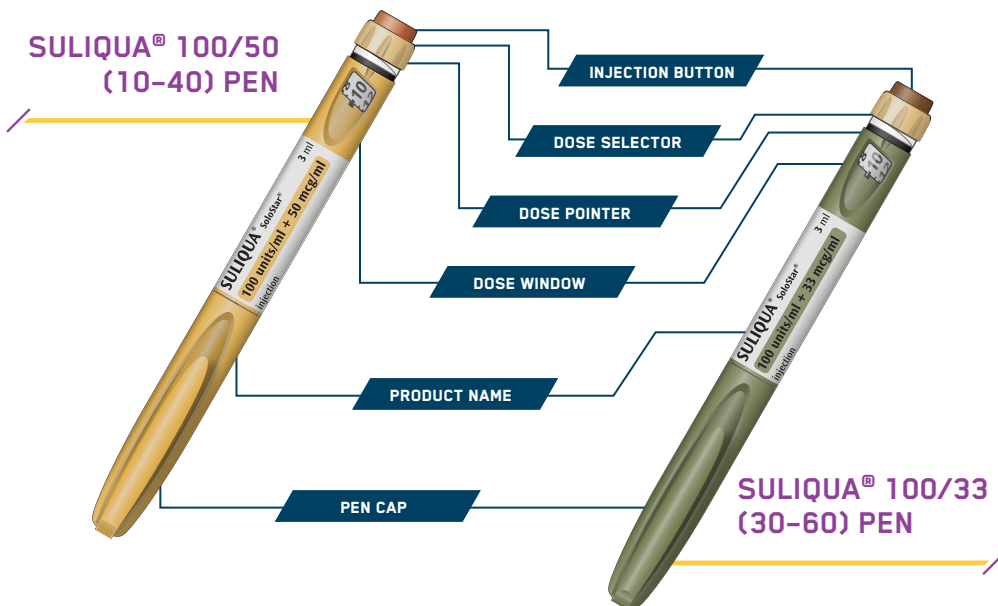

SULIQUA® CONTAINS TWO ACTIVE SUBSTANCES:

- **Insulin glargine:** a long-acting insulin that helps to control blood sugar (glucose) throughout the day
- **Lixisenatide:** a glucagon-like peptide-1 receptor agonist (GLP-1 RA) that helps the body produce its own additional insulin in response to increases in blood sugar and slows the body's absorption of sugar from food

HOW MUCH DO I USE?¹

YOU WILL HAVE BEEN PRESCRIBED ONE OF TWO AVAILABLE SULIQUA® PENS. ALWAYS USE THIS MEDICINE EXACTLY AS YOUR DOCTOR HAS PRESCRIBED. YOUR DOCTOR MAY TELL YOU TO USE A DIFFERENT DOSE OF SULIQUA® COMPARED WITH YOUR PREVIOUS INSULIN DOSE. CHECK WITH YOUR DOCTOR, PHARMACIST OR NURSE IF YOU ARE NOT SURE

1 DOSE STEP CONTAINS:

1 unit of insulin glargine + a corresponding dose of lixisenatide

	SULIQUA® 100/50	SULIQUA® 100/33
Units of insulin glargine (in 1 injection)	10-40	30-60
Dose steps	1 unit of insulin glargine and 0.5 micrograms of lixisenatide	1 unit of insulin glargine and 0.33 micrograms of lixisenatide

Your dose is administered as "dose steps". The dose window on the pen shows the number of dose steps. To ensure correct daily dosing and titration, please refer to your doctor's instruction and the patient information leaflet provided with your pen

Please carefully read the instructions included in this guide to help you get the most out of your medicine. Speak to your doctor if you have any questions about how to use SULIQUA® or your new SoloStar® pen

BEFORE USING YOUR PEN^{1,2}

Talk with your doctor, nurse or pharmacist about how to inject before using your pen and ask for help if you have any concerns. Before using your pen:

- Always read and follow the patient information leaflet that comes with your medicine
- It is important to follow these instructions to make sure that you use the correct dose prescribed for you
- Before each injection, always check the medicine packaging and label on the pen to avoid mistakes and to make sure you have the correct pen, especially if you inject more than one medicine

WHAT YOU NEED TO INJECT YOUR MEDICINE



STERILE NEEDLE*



SHARPS CONTAINER*

*Provided separately

OTHER IMPORTANT INFORMATION ABOUT USING THE PRE-FILLED PEN

- Always use a new needle for each injection. The re-use of needles increases the risk of blocked needles, which may cause underdosing or overdosing. Dispose of the needle safely after each use
- To prevent infection being passed from one person to another, pens should never be used for more than one person, even when the needle is changed
- Only use needles that are compatible for use with SULIQUA® SoloStar® pens
- A safety test must be performed before each injection as instructed by your doctor
- If you think your pen is damaged, do not use it. Get a new one. Do not try to repair the pen
- Throw away the used needle in a sharps container, or as advised by your pharmacist or local authority

Make sure that you use the pen that you have been prescribed. Check with your doctor, nurse or pharmacist if you have any concerns about using your pen

SULIQUA® 100/50 (10-40)

SULIQUA® 100/33 (30-60)

WHEN AND WHERE TO INJECT YOUR MEDICINE^{1,2}

SULIQUA® SHOULD BE ADMINISTERED UNDER THE SKIN (SUBCUTANEOUSLY) ONCE A DAY, WITHIN 1 HOUR PRIOR TO THE MOST CONVENIENT DAILY MEAL, AND AT THE SAME TIME EVERY DAY

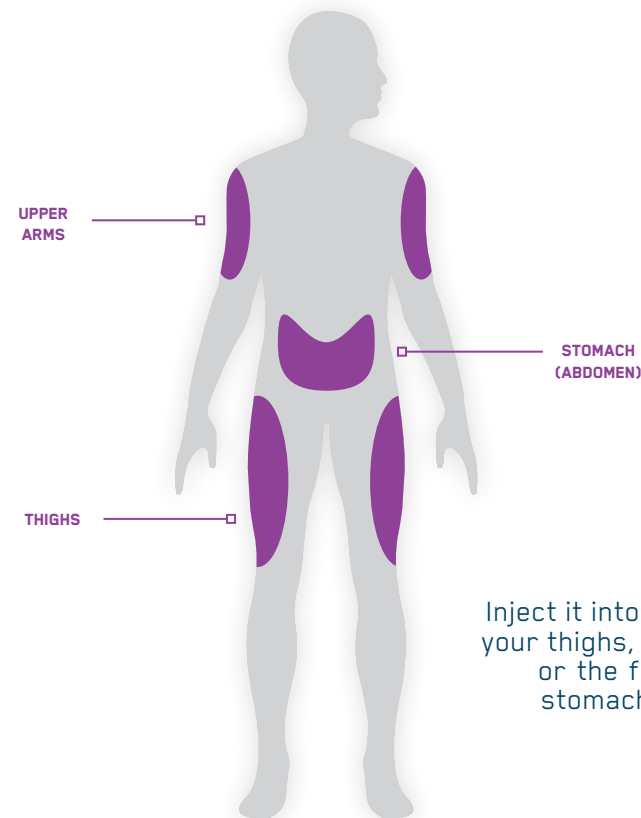

Inject it into the front of your thighs, upper arms, or the front of your stomach (abdomen)

- The injection site should be rotated to prevent skin changes such as lumps under the skin
 - The insulin may not work very well if you inject into a lumpy area
- If you are currently injecting into a lumpy area **CONTACT YOUR DOCTOR** before you start injecting in a different area. Your doctor may tell you to check your blood sugar more closely, and to adjust your insulin or your other anti-diabetic medications dose

Please carefully read the instructions included in this guide to help you get the most out of your medicine. Speak to your doctor if you have any questions about how to use SULIQUA® or your new SoloStar® pen

HOW TO INJECT IN 6 EASY STEPS²

STEP 1: CHECK YOUR PEN

Take a new pen out of the refrigerator at least 1 hour before you inject so it can warm up for a more comfortable injection

- CHECK THE NAME AND EXPIRY DATE ON THE LABEL OF YOUR PEN

Make sure that you have the correct medicine and that the expiry date has not passed



- PULL OFF THE PEN CAP



- CHECK THAT THE MEDICINE IS CLEAR

- DO NOT** use the pen if the medicine looks cloudy, coloured or contains particles, has expired, or does not match your prescription

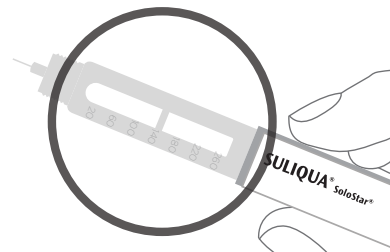

Make sure that you use the pen that you have been prescribed. Check with your doctor, nurse or pharmacist if you have any concerns about using your pen

SULIQUA® 100/50 (10-40)

SULIQUA® 100/33 (30-60)

HOW TO INJECT IN 6 EASY STEPS (CONT'D)²

STEP 2: ATTACH A NEW NEEDLE

DO NOT re-use needles. Always use a new sterile needle for each injection. This helps prevent blocked needles, contamination, and infection. Always use needles that are compatible for use with SULIQUA® pens

- TAKE A NEW NEEDLE AND PEEL OFF THE PROTECTIVE SEAL



- KEEP THE NEEDLE STRAIGHT AND SCREW IT ONTO THE PEN UNTIL FIXED. DO NOT OVERTIGHTEN

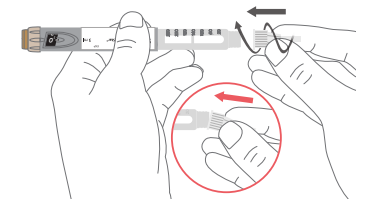

- PULL OFF THE OUTER NEEDLE CAP. KEEP THIS FOR LATER

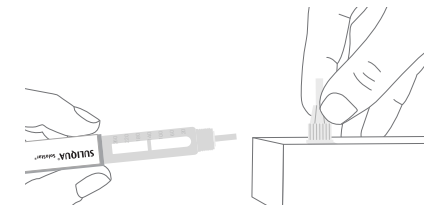

- PULL OFF THE INNER NEEDLE CAP AND THROW AWAY

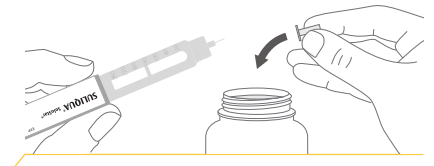

Take care when handling needles to prevent needle injury and cross-infection

Please carefully read the instructions included in this guide to help you get the most out of your medicine. Speak to your doctor if you have any questions about how to use SULIQUA® or your new SoloStar® pen

HOW TO INJECT IN 6 EASY STEPS (CONT'D)²

STEP 3: DO A SAFETY TEST

Select 2 dose steps by turning the dose selector until the dose pointer is at the 2 mark, then press the injection button all the way in. When medicine comes out of the needle tip, your pen is working correctly; the dose selector will be reset to "0"

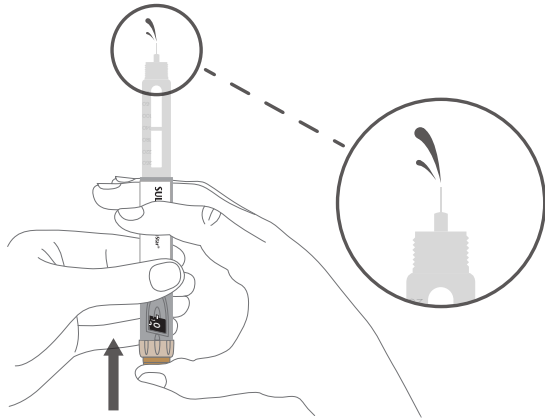

IF NO LIQUID APPEARS

- You may need to repeat this step up to 3 times before seeing medicine
- If no medicine comes out after the third time, the needle may be blocked. If this happens:
 - change the needle (see STEP 6 and STEP 2)
 - then repeat the safety test (STEP 3)
- DO NOT** use your pen if there is still no medicine coming out of the needle tip. Use a new pen
- DO NOT** use a syringe to remove medicine from your pen
- You may see air bubbles in the medicine. This is normal, they will not harm you

Your doctor will prescribe you one of two available SULIQUA[®] pens, which can both be used in the same way. Make sure that you use the pen that you have been prescribed. Check with your doctor if you have any concerns about using your pen

SULIQUA[®] 100/50 (10-40)

SULIQUA[®] 100/33 (30-60)

HOW TO INJECT IN 6 EASY STEPS (CONT'D)²

STEP 4: SELECT THE DOSE

Do not select a dose or press the injection button without a needle attached. This may damage your pen

- Make sure a needle is attached and the dose is set to "0"



- Turn the dose selector until the dose pointer lines up with your dose

If you turn past your dose, you can turn back down. If there are not enough dose steps left in your pen for your dose, the dose selector will stop at the number of dose steps left. If you cannot select your full prescribed dose, use a new pen or inject the remaining dose steps and use a new pen to complete your dose. Only in this case, it is okay to inject a partial dose of less than 10 dose steps with the 100/50 pen or less than 30 dose steps with the 100/33 pen. Always use the correct pen prescribed to you to complete your dose and no other pen

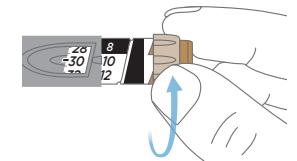

DO NOT use the pen if your single daily dose is less than 10 dose steps on the 100/50 pen or less than 30 dose steps on the 100/33 pen, shown as white numbers on a black background

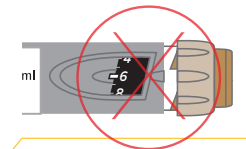

UNITS OF MEDICINE IN YOUR PEN

- YOUR PEN CONTAINS A TOTAL OF 300 DOSE STEPS. YOU CAN SELECT YOUR DOSE IN STEPS OF 1 UNIT

IF YOU HAVE THE SULIQUA[®] 100/50 PEN (10-40)

DO NOT USE THIS PEN IF YOU NEED A SINGLE DAILY DOSE THAT IS LESS THAN 10 DOSE STEPS, OR MORE THAN 40 DOSE STEPS

IF YOU HAVE THE SULIQUA[®] 100/33 (30-60) PEN

DO NOT USE THIS PEN IF YOU NEED A SINGLE DAILY DOSE THAT IS LESS THAN 30 DOSE STEPS, OR MORE THAN 60 DOSE STEPS

Please carefully read the instructions included in this guide to help you get the most out of your medicine. Speak to your doctor if you have any questions about how to use SULIQUA[®] or your new SoloStar[®] pen

HOW TO INJECT IN 6 EASY STEPS (CONT'D)²

STEP 5: INJECT THE DOSE

- Choose a place to inject as shown in the illustration on page 5

- Push the needle into your skin as shown by your healthcare provider. **DO NOT touch the injection button yet**

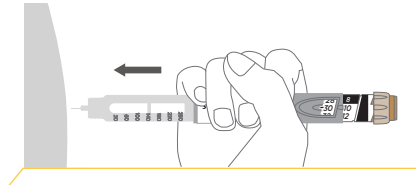

- Place your thumb on the injection button. Then press all the way in and hold. **DO NOT PRESS AT an angle. Your thumb could block the dose selector from turning**

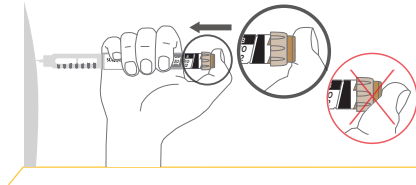

- Keep the injection button held in and when you see "0" in the dose window, slowly count to 10. This will make sure you get your full dose

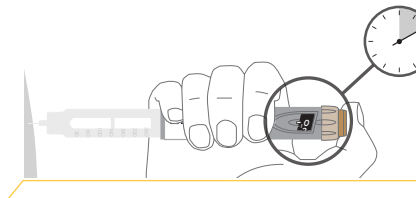

- After holding and slowly counting to 10, release the injection button. Then remove the needle from your skin

If you find it hard to press the injection button in, **DO NOT** force it as this may break your pen

Change the needle (see 'STEP 6: Remove the needle' and 'STEP 2: Attach a new needle'), then do a safety test (see STEP 3)

If you still find it hard to press in, get a new pen. **DO NOT** use a syringe to remove medicine from your pen

Please carefully read the instructions included in this guide to help you get the most out of your medicine. Speak to your doctor if you have any questions about how to use SULIQUA[®] or your new SoloStar[®] pen

HOW TO INJECT IN 6 EASY STEPS (CONT'D)²

STEP 6: REMOVE THE NEEDLE

Take care when handling needles to prevent needle injury and cross-infection

DO NOT put the inner needle cap back on

- Grip the widest part of the outer needle cap. Keep the needle straight and guide it back into the outer needle cap. Then push the cap firmly on. The needle can puncture the cap if it is recappeded at an angle

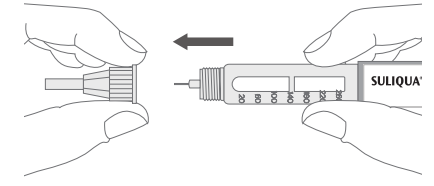

- Grip and squeeze the widest part of the outer needle cap. Turn your pen several times with your other hand to remove the needle. Try again if the needle does not come off the first time

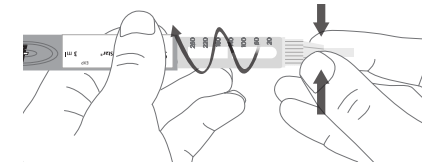

- Throw away the used needle in a puncture-resistant container

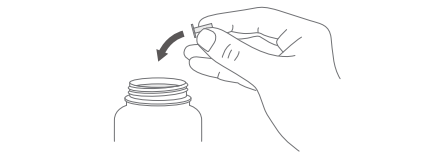

- Put your pen cap back on. **DO NOT put the pen back in the refrigerator**

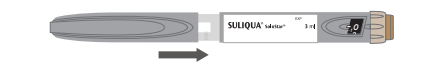

Your doctor will prescribe you one of two available SULIQUA[®] pens, which can both be used in the same way. Make sure that you use the pen that you have been prescribed. Check with your doctor if you have any concerns about using your pen

STORING YOUR SULIQUA[®] PEN^{1,2}

- Read the full “patient information leaflet” that comes with your medicine
- Make sure you read and understand the information below before you use your medicine for the first time
- Unopened pens can be stored in the refrigerator until expiration date; once opened, discard after 28 days

BEFORE FIRST USE



Store in the refrigerator at a temperature between 2°C and 8°C.* Do not freeze or place next to the freezer†



Keep in the outer carton to protect from light



Discard after the expiration date has passed

AFTER FIRST USE OR IF CARRIED AS A SPARE



Do not refrigerate or freeze an opened SoloStar[®] pen. Keep at room temperature below 25°C



Keep out of direct heat and light. Put pen cap back on the pen after each injection. Do not store with a needle attached



Discard 28 days after first use

*Before injecting SULIQUA[®], remove it from the refrigerator for at least 1 hour – cold insulin can be painful to inject

†If you see frost or ice crystals in the injection solution, throw it away

Your doctor will prescribe you one of two available SULIQUA[®] pens, which can both be used in the same way. Make sure that you use the pen that you have been prescribed. Check with your doctor if you have any concerns about using your pen

SULIQUA[®] 100/50 (10–40)

SULIQUA[®] 100/33 (30–60)

IMPORTANT SAFETY INFORMATION^{1,2}

IF YOU USE INSULIN, YOU SHOULD ALWAYS CARRY FOOD OR DRINK CONTAINING SUGAR WITH YOU (AT LEAST 20 GRAMS), AND INFORMATION THAT WILL INFORM OTHERS THAT YOU HAVE DIABETES

Like all medicines, this medicine can cause side effects, although not everybody gets them. These may include:

- Very low blood sugar (hypoglycaemia)
 - This can be very serious and is common with medicines that contain insulin. You should learn to recognise the signs when your blood sugar is falling so you can take action to stop it getting worse
 - You may experience dizziness, sweating, irregular heart beats, changes in behaviour, confusion or fainting
 - Serious hypoglycaemia may cause a heart attack or brain damage and may be life-threatening
 - If you notice signs of your blood sugar being too low, take action to increase your blood sugar level straight away
- Other common side effects include:
 - Feeling sick, vomiting and diarrhoea

PLEASE MAKE SURE THAT YOU READ THE PATIENT INFORMATION LEAFLET PROVIDED WITH YOUR SULIQUA[®] PEN FOR MORE INFORMATION

REPORTING OF SIDE EFFECTS

If you get any side effects, talk to your doctor, pharmacist or nurse. This includes any possible side effects not listed in the package leaflet. You can also report side effects directly via the Yellow Card Scheme at www.mhra.gov.uk/yellowcard

Side effects should also be reported to Sanofi Tel: 0800 090 2314. or email to UK-drugsafety@sanofi.com

By reporting side effects you can help provide more information on the safety of this medicine

References: 1 SULIQUA[®] SmPC. October 2022; 2 SULIQUA[®] Patient Information Leaflet. October 2022.

SULIQUA[®]

Insulin glargine (100 units/mL) & lixisenatide

You can find further important safety information about SULIQUA[®] by visiting:
<https://www.medicines.org.uk/emc/product/9871/rmms> for the 100/33 pen
<https://www.medicines.org.uk/emc/product/9870/rmms> for the 100/50 pen